

TERANO |

Installation Guide



Terano Installation Guide

- Walk Over: Up to 500kg (5kN).
- Maximum Static Load: Up to 2000kg (20kN) (for Opal & Clear models without Honeycomb).
- L90/B10 > 50.000h
- Ingress Protection: Ip68
- Impact resistance: Ik10



WARNING:

Make sure that the power supply is turned off during the installation procedure.

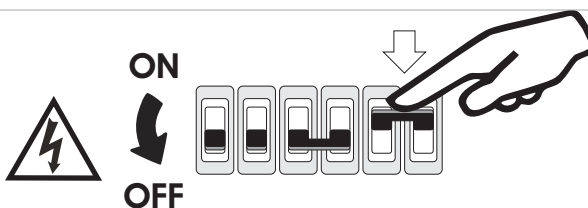

WARNING: ⚠

- The luminaire must be connected only by a qualified electrician.
- It is the user's responsibility to properly install the luminaire
- Make sure that all the local laws and regulations are followed during the installation of the luminaire.
- All connection and wiring of TERANO series are IP 68 graded.
It is the installer's responsibility to ensure that all the connections are properly executed in order to maintain the required IP wiring grade of installation.

WARNING: ⚠

The safety of this fixture is guaranteed only if you comply with these instructions. Remember to conserve the instructions in a safe place.

WARNING: ⚠

In case that the TERANO series will be installed immersed in water, make sure that the depth of 3m will not be exceeded.

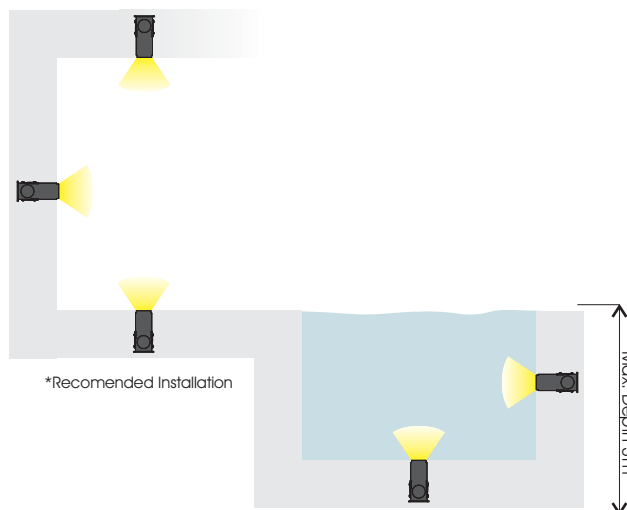

Terano Installation Guide

Model	Length	Weight*
TERANO 25 ALUMINIUM	25cm	0.75Kg
	50cm	1.50Kg
	75cm	2.25Kg
	100cm	3.00Kg
TERANO 40 ALUMINIUM	30cm	1.30Kg
	60cm	2.60Kg
	90cm	3.90Kg
	120cm	5.20Kg
TERANO 25 STAINLESS STEEL 316	25cm	1.50Kg
	50cm	3.00Kg
	100cm	6.00Kg
TERANO 40 STAINLESS STEEL 316	30cm	2.10Kg
	60cm	4.20Kg
	120cm	8.40Kg

Stainless Steel 316



Aluminium



*Approximate weight.

TERANO 25
Stainless Steel 316

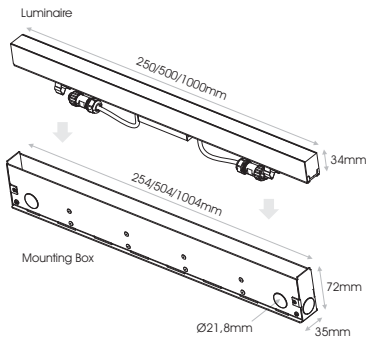
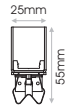

TERANO 25
Aluminium

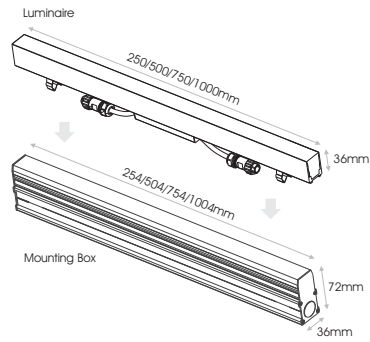
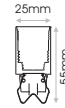

TERANO 40
Stainless Steel 316

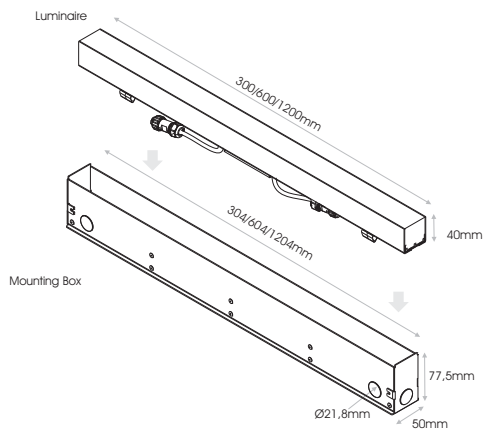
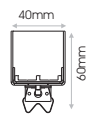

TERANO 40
Aluminium

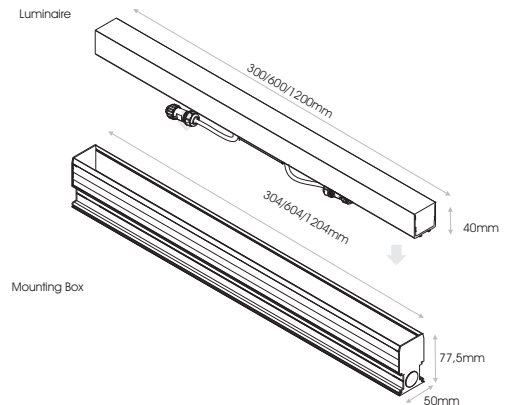
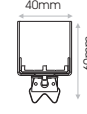

Terano Installation Guide



Place the mounting box on the installation area, the area has to be level and uniform. Secure in place using the appropriate anchors.

Aluminium

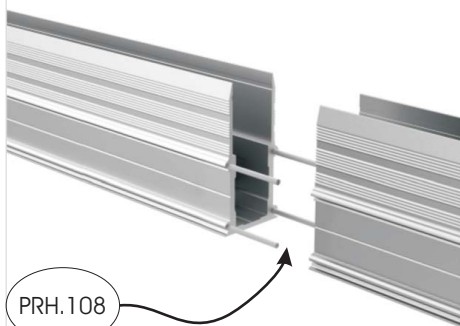

In order to mount more than one modules, for the proper alignment use the PRH.108 for the Aluminium series and the PRH.109 for the Stainless Steel series, as shown in the diagram besides.

Stainless Steel 316

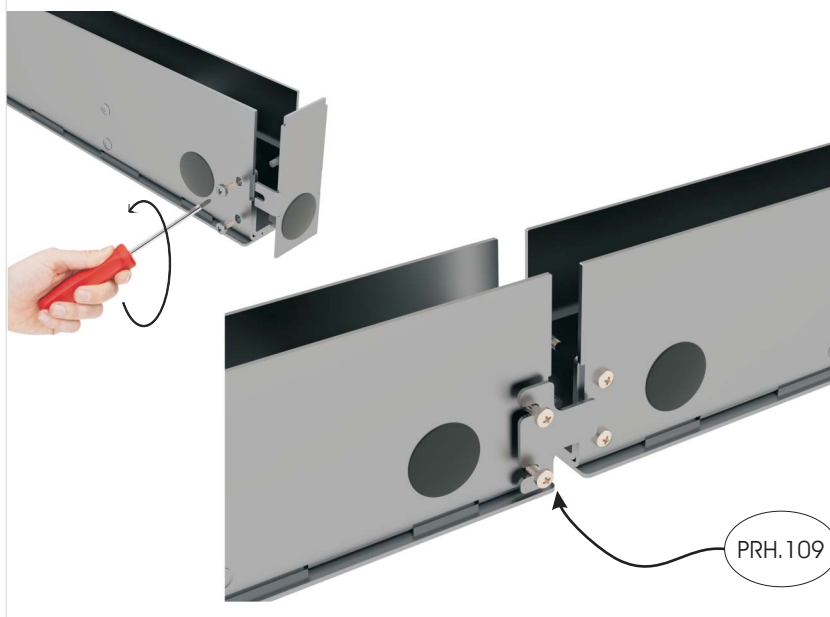

ATTENTION:

For the proper installation of the mounting boxes the installer must leave the appropriate gap between each mounting box:

- TERANO 25cm-30cm : 0.25mm
- TERANO 50cm-75cm : 0.50mm
- TERANO 90-120cmm: 1.00mm

Terano Installation Guide

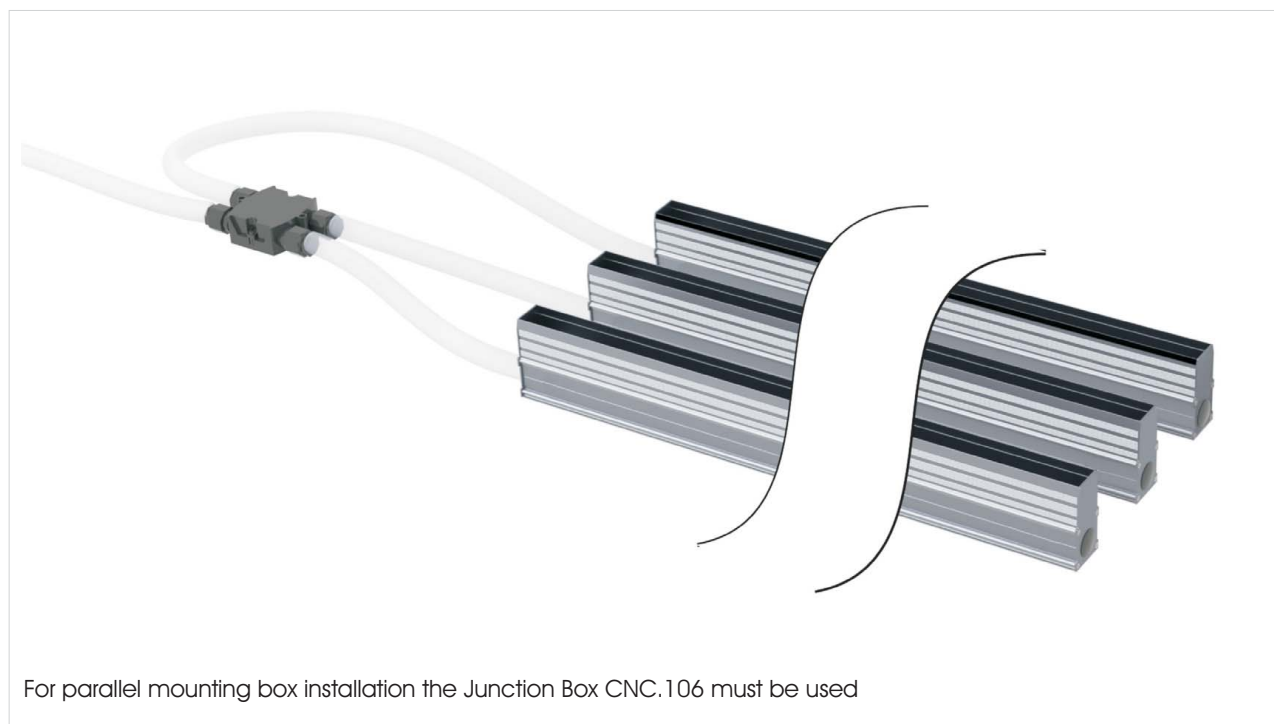
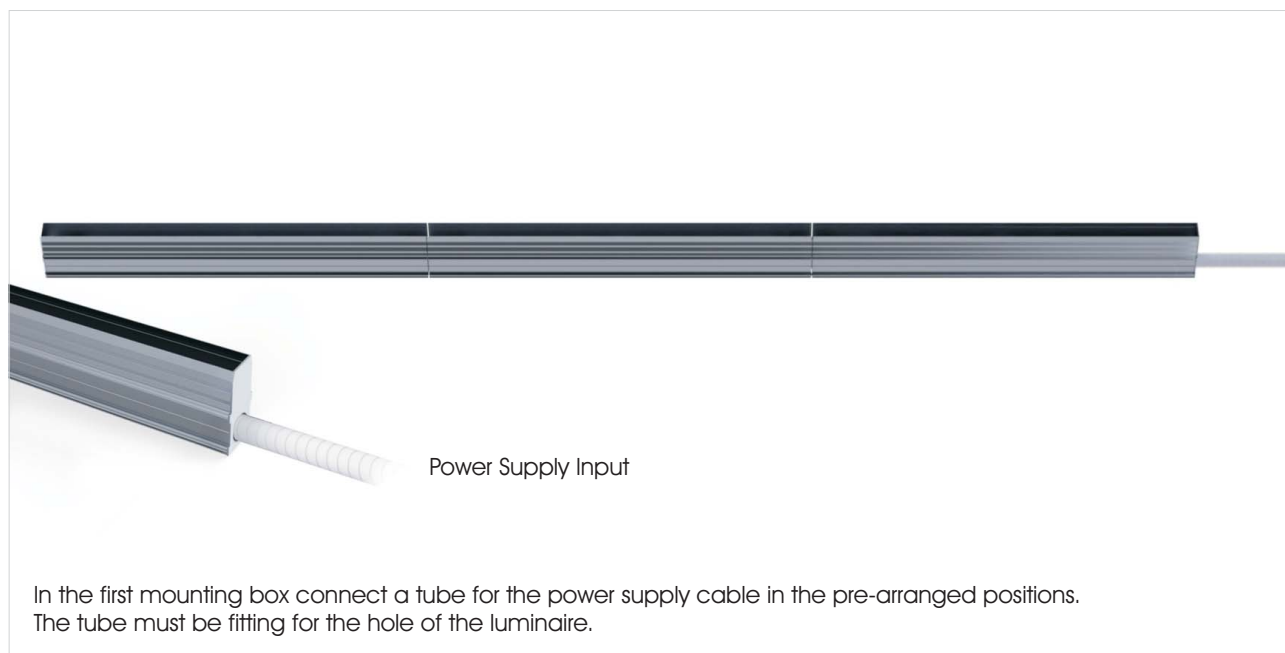

WARNING

Maximum output power for each line is:

- Monochromatic and Tunable White **280 Watt**
- RGB and RGBW **160 Watt**

Maximum input power for the CNC.106 junction box is **360 Watt**.

Terano Installation Guide

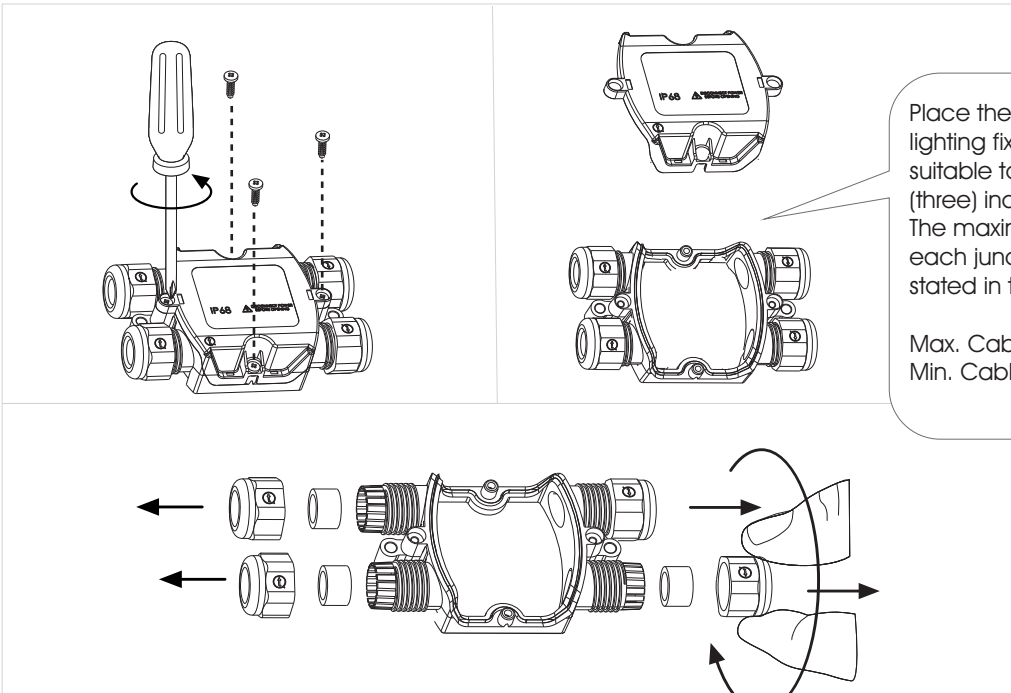

Place the junction box near the lighting fixture. The junction box is suitable to connect up to 3 (three) individual lighting fixtures. The maximum allowed power for each junction's box output is stated in the previous page.

Max. Cable diameter: **13.50mm**
Min. Cable diameter: **5.00mm**

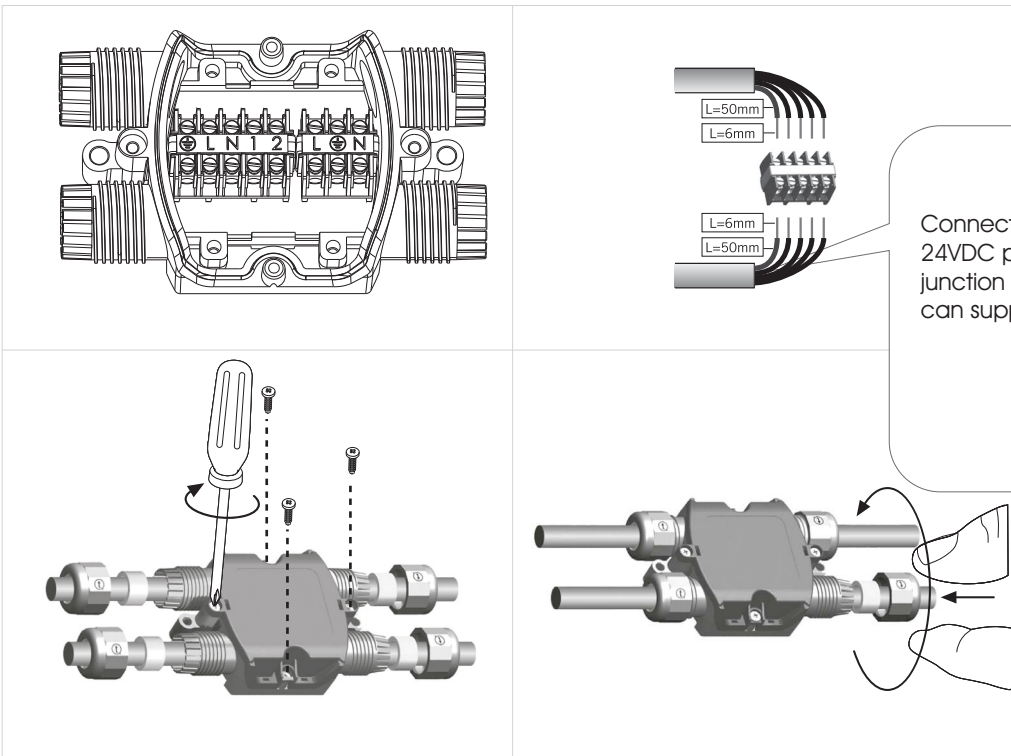

Connect the cable from the 24VDC power supply unit to the junction box. The junction box can support up to 5 poles cable.

When all the cables are connected and secured then the junction box can be screwed back in place.

Terano Installation Guide

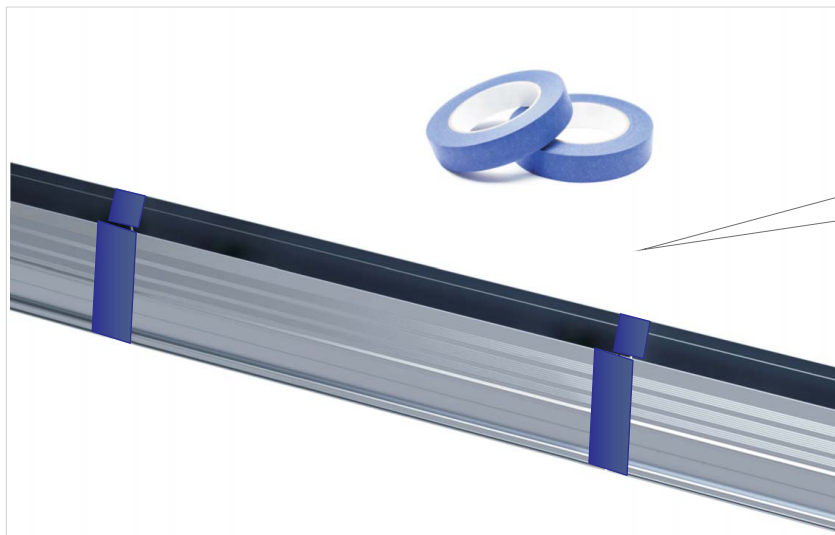

The installer must make sure that the cement will not enter the mounting box or all the other components
The usage of painters tape to fill the gaps so the cement will not enter in the mounting box, is recommended.



With the mounting box firmly secured and all the wiring done, then the provided installation aid profile can be temporary installed in place and the cement can be poured.

the installer has to ensure that the luminaire will have a proper drainage system.



When the cement is set, then the aluminium installation aid can be removed using a screwdriver.

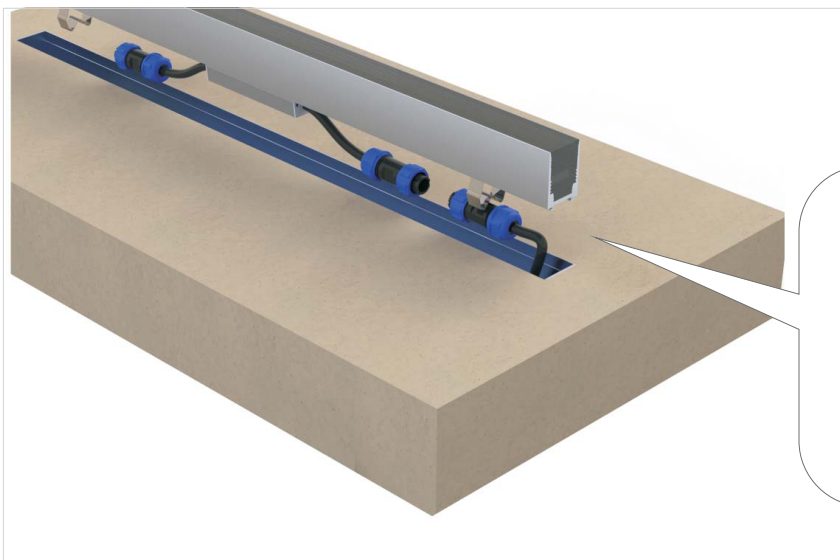

Connect the light fixture to the power supply cable as shown besides.

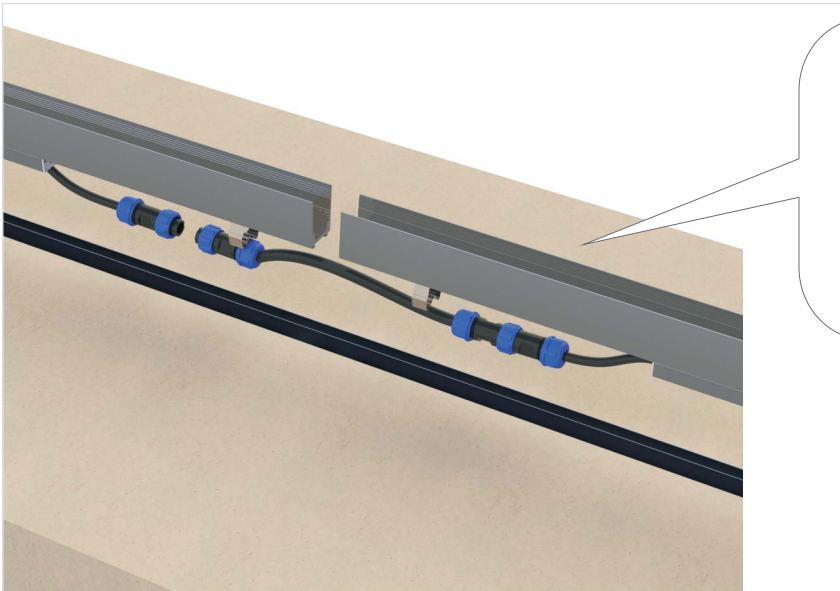

When more than one luminaire are installed, then they must be connected in line using the cable WIR.256~259.

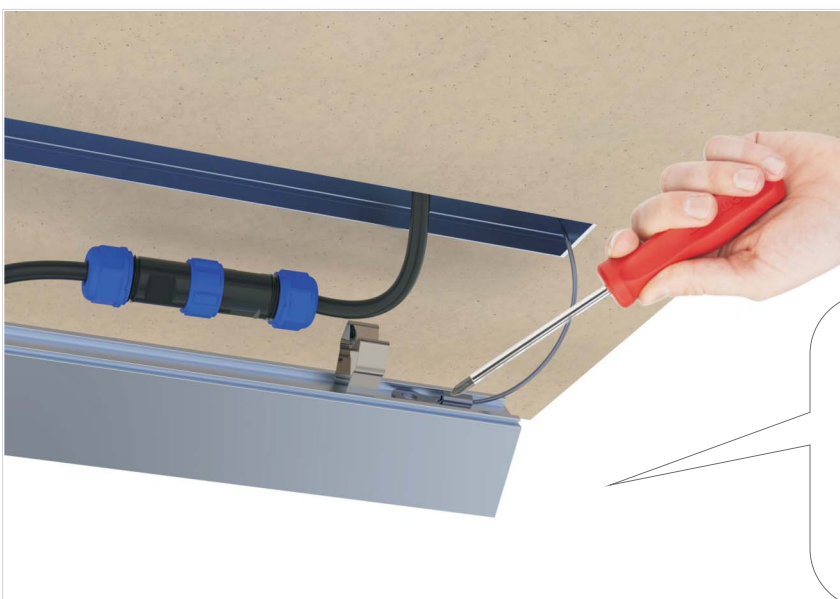

When Terano is placed in the ceiling or in the wall, then the safety wire must be attached. Place the light fixture to the side and connect the safety wire rope as shown beside.

Terano Installation Guide

Installation

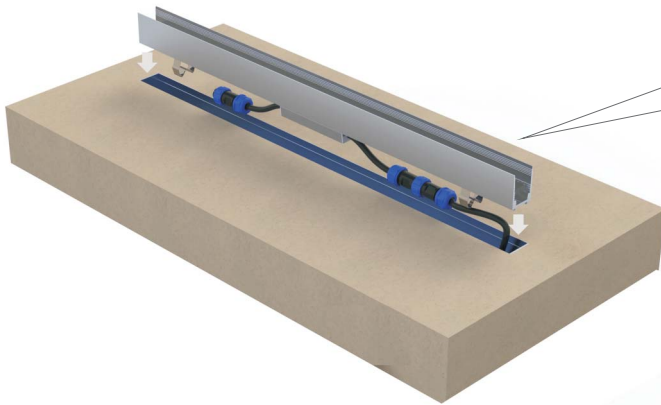

Push the luminaire fixture into the mounting box. Make sure that the cables are not interfering with the mounting clips.



In order to remove the lighting fixture, then the disassembly kit PRH.110 must be used.

TERANO

Installation Guide